

uPVC SWR

Drainage Systems



Best Quality



Cost Effective



No Leakage, Blockage or Breakage



UV Stabilised



Apollo Pipes Ltd.

Email: info@apollopipes.com | Web: www.apollopipes.com



1800-121-3737
011-43334000



Products: CPVC PIPES & FITTINGS | uPVC PLUMBING SYSTEM | PRESSURE PIPES & FITTINGS | uPVC SWR Drainage System | COLUMN PIPES | WELL CASING PIPES | HDPE PIPES | SPRINKLER SYSTEM

About Apollo Pipes

APOLLO PIPES LTD. is the key group company of Sudesh Group. The company has an enriching experience of decades in manufacturing pipes and related products for all purposes. With a manufacturing plant having 20 extrusion lines and producing 60,000 tonnes of polymers annually, APOLLO PIPES LTD. has the largest manufacturing unit at a single location under one roof in North India. APOLLO PIPES LTD. business activities are focused on development, manufacturing and distribution of Plastic Piping Systems under the brand name of APL APOLLO.

APOLLO PIPES have plants located at Dadri, Sikandrabad (Uttar Pradesh) and Ahmedabad (Gujarat). The plants use flexible manufacturing techniques, greener technologies and modern machinery. We strictly follow the national and international standards while manufacturing all kinds of CPVC Pipes and Fittings, uPVC Plumbing System, uPVC SWR Drainage Systems, uPVC Pressure Pipes and Fittings, Elastomeric (Ring Fit Pipes), Column Pipes, uPVC Well Casing Pipes, HDPE Pipes, Sprinkler System and Cable Ducts.



uPVC SWR Drainage System

APL Apollo uPVC SWR Drainage System is an easy & economical product for drainage of soil waste & rain water application in residential, commercial & industrial buildings conforming to ISI-13592-92 & the Fittings conforming to ISI-14375-99, with many advantages over the conventional piping systems.

uPVC SWR Drainage System offers a maintenance-free solution for a longer & non-rusting and corrosion service life.

APL Apollo uPVC SWR Pipes Conforms To IS 13592-1992

Nominal Outside Diameter D (mm)	Tolerance on Outside Diameter D (mm)	Wall Thickness Type - A (mm)		Wall Thickness Type - B (mm)	
		Min	Max	Min	Max
75	± 0.3	1.8	2.2	3.2	3.8
90	± 0.4	1.9	2.3	3.2	3.8
110	± 0.4	2.2	2.7	3.2	3.8
160	± 0.5	3.2	3.8	4	4.6

Product specifications and Pipes range are available in 75, 90, 110 and 160 mm and Fittings are available in 75 mm to 160 mm sizes. Pipes conforms to IS 13592:92 and Fittings conforms to IS 14375 and are made as per international standards. uPVC SWR Drainage System is available in – Rubber ring type joints – Fix 'O' ring type seal design.



uPVC SWR Features and Benefits

Manufactured from quality raw material	<ul style="list-style-type: none"> ➤ APL Apollo uPVC SWR Drainage System (Offer High Strength & Durability)
World class machining	<ul style="list-style-type: none"> ➤ APL Apollo uPVC SWR Drainage System are manufactured on most sophisticated State-of-the-Art machines to ensure a flawless product at every time
APL Apollo uPVC SWR Pipes are lighter in weight than the conventional metal pipes	<ul style="list-style-type: none"> ➤ Easy handling, transportation and installation
Economical	<ul style="list-style-type: none"> ➤ uPVC SWR Drainage System cost less than that of the other alternatives ➤ Cost of transportation, handling and installation is lower
APL Apollo uPVC SWR Drainage System offers excellent chemical resistance	<ul style="list-style-type: none"> ➤ Non-reactive with acidic & alkali substances in water, ideal for drain water discharge as well as numerous number of chemicals like strong minerals, acids that could be therein ➤ Non-Corrosive, ensures longer lifecycle
uPVC is non-conductive	<ul style="list-style-type: none"> ➤ APL Apollo uPVC SWR Drainage System offers excellent life avoiding electro-chemical reactions, which generally lead to encrustation of pipes
Longevity of lifecycle	<ul style="list-style-type: none"> ➤ APL Apollo uPVC SWR Pipes generally have a lifecycle of more than 50 years, which saves on replacement and replenishment costs
APL Apollo uPVC SWR Drainage System are manufactured under stringent quality standards	<ul style="list-style-type: none"> ➤ APL Apollo uPVC SWR Drainage System offers a reliable piping system which is highly resilient, tough & durable with excellent impact strength
Ease of use	<ul style="list-style-type: none"> ➤ APL Apollo uPVC SWR Drainage Systems offer fast & easy jointing which saves on time & cost of the installation and promises a long & reliable service life
Easy access for cleaning & clearing obstruction	<ul style="list-style-type: none"> ➤ APL Apollo uPVC SWR Drainage System is designed to facilitate easy access for cleaning & clearing any obstructions
No chocking of the drainage system	<ul style="list-style-type: none"> ➤ APL Apollo uPVC SWR Drainage Systems have a smoother (inner) surface as compared to the alternate products maintaining smooth flow of the discharge & minimal obstructions which cause deposits inside the drainage system
Leak-proof joints	<ul style="list-style-type: none"> ➤ APL Apollo uPVC SWR Drainage System is designed to provide leak-proof drainage system, it provides for special rubber rings at the joints which ensures leak-proof joints
Exceeds in reliability	<ul style="list-style-type: none"> ➤ UV stabilised ➤ Suitable for outdoor application ➤ Offers longer lifecycle

uPVC SWR FITTINGS WITH RINGS (AS PER IS: 14375)



uPVC SWR FITTINGS WITH RINGS (AS PER IS: 14375)



uPVC SWR FITTINGS SELF FIT (AS PER IS: 14375)

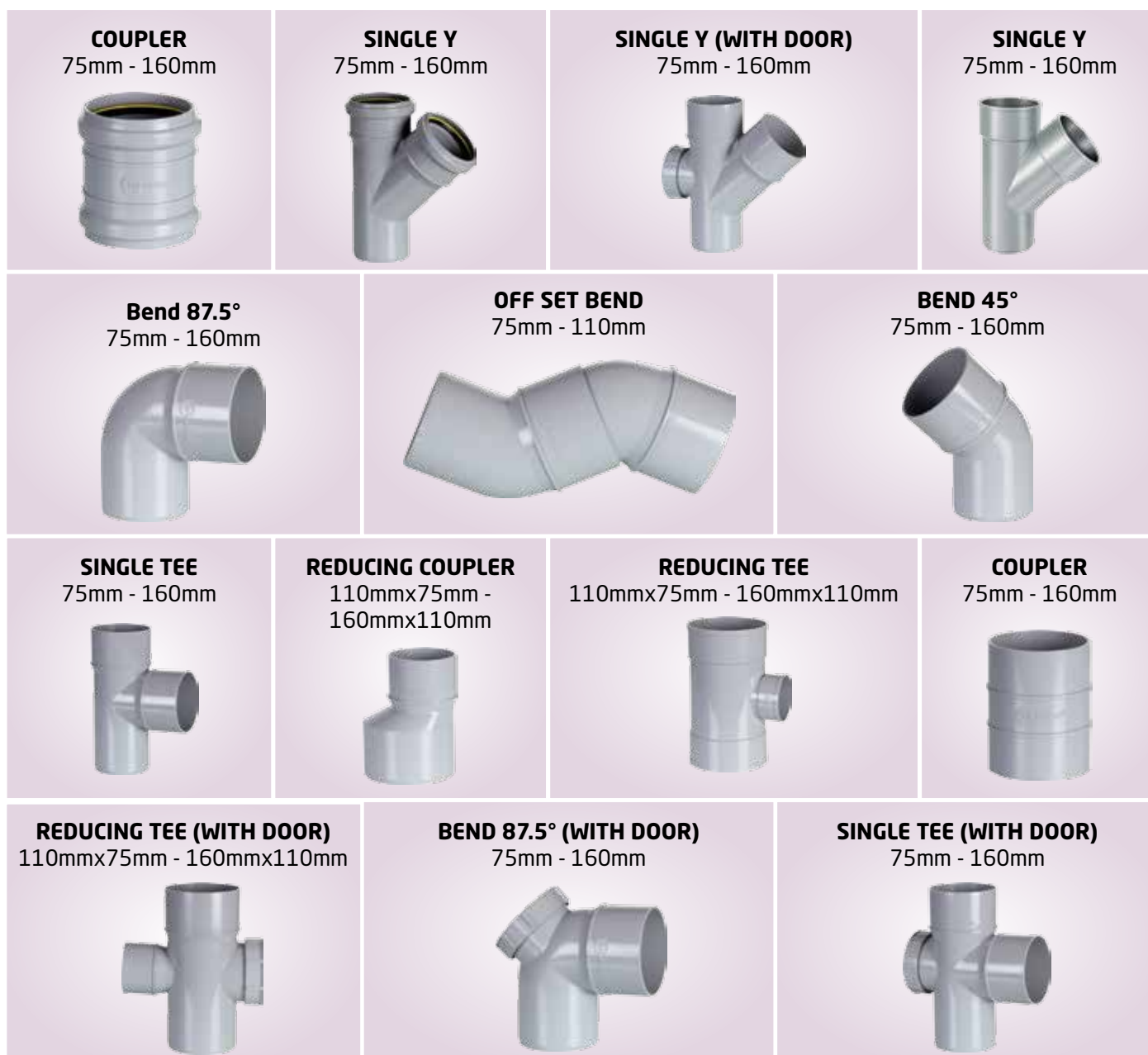

Installation Guide Ringfit

Easy and 100% leakproof installation.

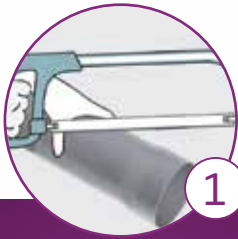

1

STEP 1: CUTTING: firstly , measure & cut the pipes straight and square. Inspect pipe ends thoroughly before making the cut, if any cracks or split in the ring is noticed cut off a minimum of 25 mm beyond the visible crack before proceeding.



2

STEP 2: CHAMFERING AND DEBURRING: Burrs in and on the pipe end can obstruct flow/proper contact between the pipe and socket of the fitting during assembly and should be removed from both in and outside of the pipe. A 15 mm dia half round file/a pen knife or a deburring tool are suitable for this purpose.

A slight bevel on the end of the pipe will ease entry of the pipe into the socket of the fitting socket.



3

STEP 3: FITTING PREPARATION: Use a clean dry cloth to wipe out the dirt & moisture from the fitting and pipe end.



4

STEP 4: CHECK FOR YELLOW SEAL™: Check the socket end for Yellow Seal™. Ensure that the yellow part of the seal is towards the outside of socket.



6

STEP 6: ASSEMBLY: Immediately insert the pipe into the fitting socket. Rotate the pipe slightly while inserting. Withdraw pipe until the mark is 12 mm away from socket. This means a 12 mm gap exists between the end of the pipe and the socket register. This gap will allow the pipe to expand without distorting the pipe-work jointing..



5

STEP 5: LUBRICANT: Apply the lubricant on the chamfered end of the pipe.

APL Apollo Ringfit Pipes and Fittings are joined with the help of APL Apollo Lubricant. For faster plumbing and leak proof joints we strongly recommend the use of APL Apollo lubricants only.

Ring Fit-Star of the product

APL APOLLO RING ('O' RING TYPE) can be join together by simply pushing into the socket end. This requires no threading or solvent for joining. That end is held firmly in the socket by the reinforced Yellow Seal provided in the groove. It ensures leak-proof joints that can withstand high pressure and prevents choking. This system is made in high tech, new generation machines that ensure correct thickness, dimensional stability part after part. This advanced co-moulded ring – Yellow Seal™, enables the joints to withstand high pressures and also compensates for the thermal expansion and contraction of plastic.

The Yellow Seal sits in the groove of the socket and is

permanently positioned by the advanced co-moulded plastic unlike conventional rubber rings, which have a tendency to come out during fitment. Superior Yellow Seal Technology o solvent cement is required to make joints. These are manufactured at par with international standards and are strictly monitored for quality and consistency."



Installation Guide self fit

Easy and 100% leakproof installation.



1

STEP 1: CUTTING: You can easily cut the pipe with a plywood cutting saw as squarely as possible (at 90°) provides optimal bonding area within a joint. If a crack is noticed cut-off a minimum of 25 mm beyond the visible crack before proceeding.



3

STEP 3: FITTING PREPARATION: Use a dry rag to wipe the dirt and moisture from the fittings and pipe. Dry fit the pipe to ensure total entry into the bottom of the fittings socket and make a visible marking using a felt tip pen.



2

STEP 2: DEBURRING/BEVELING: Burrs in pipe end can obstruct proper contact between the pipe and the fitting during assembly and should be removed. A 15 mm dia half round file/a pen knife or a deburring tool are suitable for this purpose. A slight bevel on the end of the pipe will ease entry of the pipe into the socket of the fitting socket.



4

STEP 4: SOLVENT CEMENT APPLICATION: Apply an even coat of solvent cement on the pipe and the socket end of the fitting. Do not use thickened or lumpy solvent cement. It should have a flow consistency like that of syrup or paint.



5

STEP 5: ASSEMBLY: Immediately insert the pipe into the fitting socket, rotate the pipe $\frac{1}{4}$ to $\frac{1}{2}$ turn while inserting. This motion ensures an even distribution of cement within the joint. Hold the assembly for 10 seconds to allow the joint to setup.

APL Apollo selfFIT Pipes and Fittings are joined with the help of APL Apollo SwR solvent cement, which is a single step fast setting solvent cement. The bonding takes place due to chemical fusion of the mating surfaces.

Our Product Range

- CPVC Pipes & Fittings** : APL Apollo CPVC Pipes & Fittings (as per ASTM D-1784, ASTM D-2846, ASTM F-439, ASTM F-441, ASTM F-438 & ASTM F-493) is a safe, long lasting and cost-effective solution for hot and cold water. This system is suitable for all plumbing and potable water application.
- uPVC Plumbing System** : APL Apollo uPVC Plumbing System (as per ASTM D-1785 & ASTM D-2467) being lead-free and non-toxic is favourable for carrying potable water. It is used for high pressure water distribution plumbing in residential, commercial and industrial buildings.
- Pressure Pipes & Fittings** : These pipes and fittings are used in variety of applications like irrigation , water supply, industrial process line, swimming pools, fire fighting, etc.
- Column Pipes :** APL Apollo Column Pipes are manufactured for borewell / submersible pumps which offer many advantages like-light weight, high tensile load capacity, leak-proof joints and long life with economy and hence, emerges as the best option for conventional metal pipes.
- Well Casing Pipes** : APL Apollo uPVC Well Casing Pipes an ideal preference for applications like protection of domestic, irrigation, industrial and mining borewells.
- HDPE Pipes** : HDPE is strongly resistant to stress cracking and has low creep rupture properties. It has excellent insulation properties over a wide range of frequencies and is not chemically active.
- Sprinkler System** : APL Apollo Sprinkler System (as per IS:14151) is suitable for almost all field crops like wheat , gram, pulses as well as vegetables, cotton, soya bean, tea, coffee and other fodder crops, Suitable for residential, industrial, hotel, resorts, public & government enterprises, golf links, race courses, etc.

Apollo Pipes Ltd., 37, Hargobind Enclave,
Vikas Marg, New Delhi - 110092
Email: info@apollopipes.com |
Web: www.apollopipes.com



1800-121-3737
011-43334000